



Sink - MEM

Drain Umbrella drain, can not be closed 1 1/4" - Dark Platinum matte

Article number: 10 126 970-99 0010



- Min. basin thickness 5/8"
- can not be closed
- Commonly used with basins without overflow.

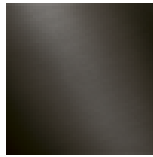

Dark Platinum matte

All dimensions in mm / inch = mm x 0,0394



Sink - MEM

Drain Umbrella drain, can not be closed 1 1/4" - Dark Platinum matte

Article number: 10 126 970-99 0010



Sink - MEM

Drain Umbrella drain, can not be closed 1 1/4" - Dark Platinum matte

Article number: 10 126 970-99 0010

Other surface finishes



polished chrome

10 126 970-00 0010



platinum matte

10 126 970-06 0010



platinum

10 126 970-08 0010

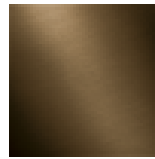

Dark Brass matte

10 126 970-16 0010



Dark Bronze matte

10 126 970-17 0010

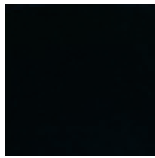

black matte

10 126 970-33 0010



Cyprum

10 126 970-49 0010

More custom finish options are available via special production (xTra Service). Please see our finish matrix for availability and pricing or contact a Dornbracht representative.



Sink - MEM

Drain Umbrella drain, can not be closed 1 1/4" - Dark Platinum matte

Article number: 10 126 970-99 0010

Spare parts list

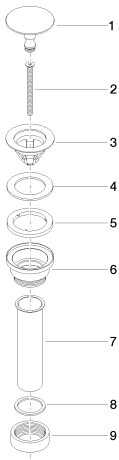

Number	Item Number	Designation	Number of units
1	09 31 20 097-99	plug	1
2	09 30 30 179 90	Mounting bracket -	1
3	09 11 01 038-99	cup	1
4	09 14 05 061 90	Washer -	1
5	09 14 03 153 90	Washer -	1
6	09 11 10 156-99	connection	1
7	09 28 20 055-99	pipe	1
8	09 14 05 062 90	Washer -	1
9	09 23 30 073-99	Mounting bracket - Dark Platinum matte	1